

GECMA RT safe area unit

19" Rack mounted version copper



* 4 Channel Rack Version

The GECMA RT safe area unit is a single video channel transmission unit. It enables the transparent Keyboard-Video-Mouse (KVM) transmission via Copper CAT-6A cable from the safe area into the hazardous area through an intrinsically safe, digital data transmission. A distance of up to 100m can be reached at a resolution of up to 1920x1200 pixel depending on the version of the safe area unit.

Features

Digital Video In	DVI-D (Digital only - VGA on request)
Digital Video Out	DVI-D (Digital only)
USB In	Transparent USB 2.0 connection for keyboard and pointing device
RS232	Single channel RS232 connection
Copper	I.S. Copper
Category	Copper CAT-6A
Bandwidth	500 MHz
Distance	up to 100m
Resolution	up to 1920 x 1200 pixel, Full HD 1080p resolution at 1920x1080 @ 60Hz and 16:9 picture format
Designation	GECMA RT safe area unit /19" rack mounted version
Housing	19" plug in, 1HE (1U)
Power Supply	100 - 240 V AC / 50/60 Hz /, typical: 10W maximum: 48 W
Power Input	25 W (with 4 outputs)
Connections	DVI/VGA IN, DVI OUT, RS232 IN, USB IN, COPPER I.S.
Fuses	2 x 2 AT

Technical data sheets are subject to modifications and amendments / No liability for misprints and errors.

GECMA RT safe area unit- 19" Rack mounted version

September 2016

Features

Dimensions	430mm Width x 44mm Height x 220mm Depth (Body) 483mm Width x 44mm Height x 264mm Depth (Total)
Weight	5,0 kg
Certified Ambient Temperature	-30 °C ≤ Ta ≤ +60 °C
Operating Ambient Temperature	-10 °C ≤ Ta ≤ +50 °C

Article Codes

GECMA RT Safe Area Unit 19" Rack Version

1 Terminal	GEC-GE1RT-TRC01-00
2 Terminals	GEC-GE1RT-TRC02-00
3 Terminals	GEC-GE1RT-TRC03-00
4 Terminals	GEC-GE1RT-TRC04-00

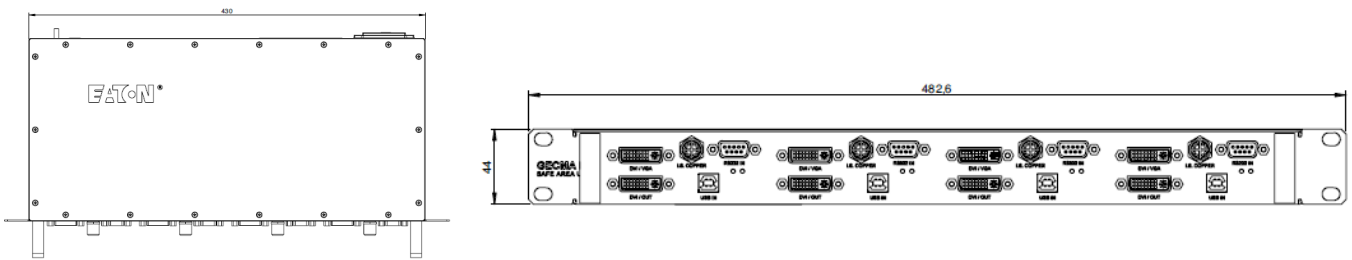

Standard Setup with DVI/ USB Connection

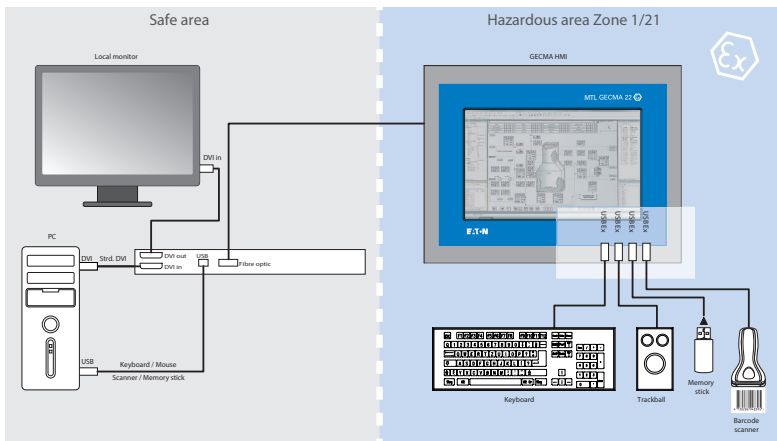

Eaton Electric Limited,
Great Marlings, Butterfield, Luton
Beds, LU2 8DL, UK.
Tel: + 44 (0)1582 723633 Fax: + 44 (0)1582 422283
E-mail: mtlenquiry@eaton.com
www.mtl-inst.com

© 2016 Eaton
All Rights Reserved
Publication No. EPS GECMA RT SAU Rack rev 2 210916
September 2016

EUROPE (EMEA):
+44 (0)1582 723633
mtlenquiry@eaton.com

THE AMERICAS:
+1 800 835 7075
mtl-us-info@eaton.com

ASIA-PACIFIC:
+65 6 645 9888
sales.mtlsing@eaton.com

The given data is only intended as a product description and should not be regarded as a legal warranty of properties or guarantee. In the interest of further technical developments, we reserve the right to make design changes.