



This Eaton designed drain valve is a sprung loaded open poppet type check valve which automatically permits draining of the refueling gallery. The valve shuts during refueling operations and contains a sprung loaded flap valve to prevent reverse flow into the gallery. The valve opens when the manifold pressure is low (below 3psi (20.68kPa)) to drain trapped fuel into the tank and minimize unusable fuel.

Design Features

- Lightweight design
- Connection fitting to MS 33514-E6 (9/16 X 18 UNJF 3A)



Powering Business Worldwide

Specification

Drain Valve Part No. HTE310028
 Space Envelope 56.90 x 50.80 x 29.97mm
 (2.24 x 2.0 x 1.18in)
 Operating Pressure. 0-120psig (0-827kPa)
 Proof Pressure 240psig (1655kPa)
 Ultimate Pressure. 360psig (2482kPa)
 Leakage (External) NIL
 Leakage (Internal) 5 -150cc/min @ 3- 65psig
 (20.7 - 448.16kPa)
 Dry Weight 0.062kg (0.136lb)
 Temperature Range -55°C to +85°C (-67°F to 185°F)
 Altitude -2000ft to 43,100ft
 Endurance. 100,000 Cycles
 Operating Media. Aviation Fuel
 Cracking Pressure. Open by 0.06psig (0.414kPa)
 Closing Pressure. Closed by 3psig (20.68kPa)

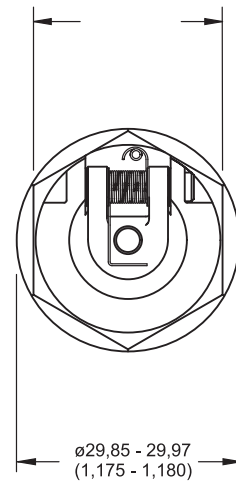
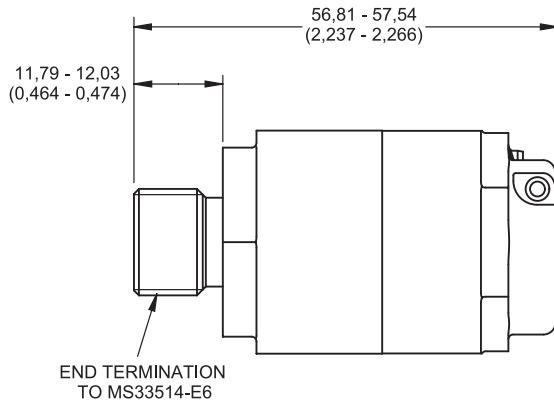

Dimensions in mm (in)

Eaton Aerospace Limited
 Aerospace Group
Fuel Systems Division
 Abbey Park, Southampton Road
 Titchfield, Fareham
 Hampshire, PO14 4QA
 UK
 Tel: +44 (0)1329 853000
 Fax: +44 (0)1329 853797
 www.eaton.com/aerospace

Eaton Aerospace Limited
 Aerospace Group
Fuel Systems Division
 Pathfields Business Park
 Station Road, South Molton
 Devon, EX36 3DW
 UK
 Tel: +44 (0)1769 573371
 Fax: +44 (0)1769 572755

Eaton
 Aerospace Group
Fuel Systems Division
 23555 Euclid Avenue
 Cleveland, Ohio 44117
 USA
 Tel: (216) 692-6000
 Fax: (216) 692-6331

Eaton
 Aerospace Group
Fuel Systems Division
 9650 Jeronimo Road
 Irvine, California 92618
 USA
 Tel: (949) 452 9500
 Fax: (949) 452 9991